

**MODEL NO.:#465**

## **USER MANUAL**

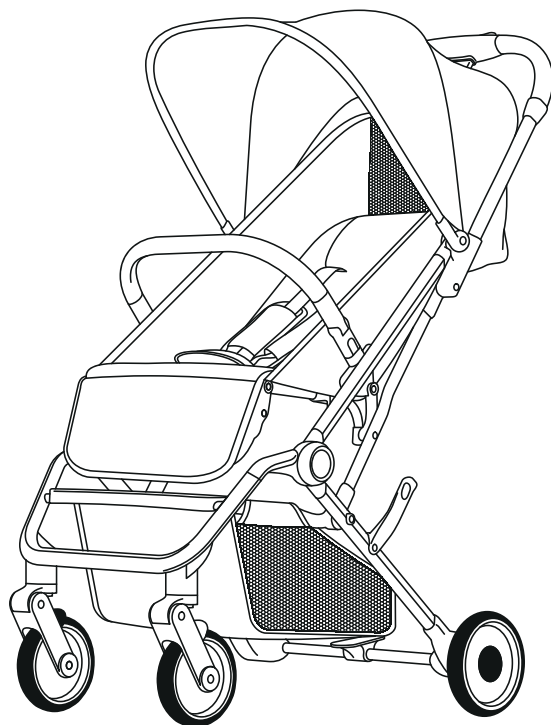

**Scan the QR code to register your product**

<https://www.evolorbaby.com/customer-care/product-registration/>



**Important: Keep these instructions for future reference.**

## **WARNING**

Thank you for choosing Dream On Me and congratulations on joining The DOM Family, a family that has been transforming lives for 30 years! We appreciate your feedback and wish you the very best in the coming years with your new addition. If you have any questions or concerns please don't hesitate to reach out and a trusted DOM representative will assist you. Thank you again for entrusting us to supply you with the safest, functional and affordable baby products and accessories. Feel free to follow us on Facebook and Instagram for further opportunities and offers.

**Failure to follow these warnings and the assembly instructions could result in serious injury or death.**

- **ADULT ASSEMBLY REQUIRED.**
- **NEVER LEAVE CHILD UNATTENDED.** Always keep child in view while in stroller.
- **AVOID SERIOUS INJURY** from falling or sliding out. Always use seat belt. After fastening buckles, adjust belts to get a snug fit around your child.
- **AVOID FINGER ENTRAPMENT:** Use care when folding and unfolding the stroller. Be certain the stroller is fully erected and latched before allowing your child near the stroller.
- **NEVER USE STROLLER ON STAIRS** or escalators. You may suddenly lose control of the stroller or your child may fall out. Also, use extra care when going up or down a step or curb.
- **DO NOT** place items with a string around your child's neck, suspend strings from this product, or attach strings to toys.
- **USE OF THE STROLLER** with a child weighing more than 40 lb (18 kg) or taller than 45 inches (114.3cm) will cause excessive wear and stress on the stroller. Use the stroller with only one child at a time.
- **TO PREVENT A HAZARDOUS, UNSTABLE CONDITION,** never place purses, shopping bags, parcels or accessory items on the handle. Never place anything on the canopy.
- **TO PREVENT A HAZARDOUS, UNSTABLE CONDITION,** do not place more than 10 lb (4.5 kg) total in the storage basket.
- **DO NOT** use storage basket as a child carrier.
- **DO NOT ALLOW** your child to stand on the basket. It may collapse and cause injury.
- **NEVER PLACE** child in the stroller with head toward footrest.
- **NEVER ALLOW YOUR STROLLER** to be used as a toy.
- **DISCONTINUE USING YOUR STROLLER** should it become damaged or broken.
- **STROLLER TO BE USED** only at walking speed product not intended for use while jogging, skating, etc.
- **CAREGIVER MUST** always help child get into and out of the stroller.

## **WARNING**

**THE STROLLER IS DESIGNED FOR USE ON FLAT OR GENTLY SLOPING SURFACES, AND MAY BE UNSTABLE ON HIGHER SLOPING AND UNEVEN SURFACES. USERS SHOULD BE AWARE OF THE POSSIBILITY OF THE STROLLER ROLLING AWAY OR TIPPING OVER.**

- PUSH THE STROLLER HOLDING BOTH HANDS.
- THE STROLLER CAN BE STEERED IN THE DESIRED DIRECTION - ALLOWING THE FRONT WHEELS TO SWIVEL WILL MAKE THIS EASIER.
- THE FRONT WHEELS MAY WOBBLE OR OSCILLATE WHEN WALKING FAST. LOCKING THE FRONT SWIVEL WHEELS WILL FIX THEM IN POSITION.
- THE STROLLER CAN BE TAKEN UP CURBS BY EITHER PUSHING DOWN ON THE HANDLE BAR, THEREBY RAISING THE FRONT WHEELS AND MOUNTING THEM ON THE CURB. OR, YOU CAN TURN THE STROLLER AROUND AND PULL THE STROLLER UP THE CURB.
- CAUTION IS REQUIRED WHEN PUSHING THE STROLLER ACROSS STEEP SLOPES OR UNEVEN SURFACES THIS MAY CAUSE STROLLER TO BECOME UNSTABLE AND FALL OVER. ALWAYS HOLD THE HANDLE BAR FIRMLY.
- WHENEVER YOU STOP, ALWAYS APPLY THE BRAKES BEFORE YOU LEAVE THE STROLLER.
- DO NOT HANG BAGS OR GOODS FROM THE HANDLE BAR, AS THIS COULD CAUSE THE STROLLER TO TIP OVER. USE THE STORAGE BASKET.

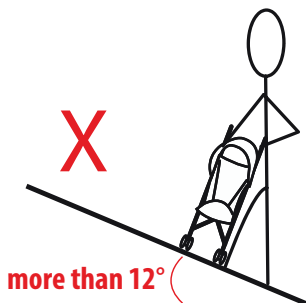
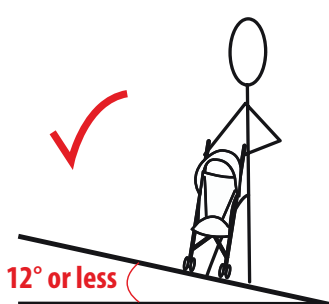

## **WARNING**

- THE UPRIGHT POSITIONS ARE NOT SUITABLE FOR A CHILD UNDER 6 MONTHS OLD.
- THE LOWEST RECLINE POSITION SHOULD BE USED TO TRANSPORT BABIES. THE BACKREST CAN BE ADJUSTED TO A MORE UPRIGHT POSITION AS THE CHILD GROWS OLDER AND IS ABLE TO SUPPORT ITS HEAD WITHOUT ASSISTANCE.



# CARE AND MAINTENANCE

- To prolong the life of your stroller, keep it clean and do not leave it in the direct sunlight or in the car for extended periods of time.
- Removable fabric covers and trims may be cleaned using warm water with a household soap or mild detergent. Allow it to dry fully, preferably away from the direct sunlight.
- Non removable fabric covers and trims may be spot cleaned using a damp sponge with soap or a mild detergent. Allow it to dry completely before folding or storing it away.
- In some climates, the covers and trims may be affected by mold and mildew. To help prevent this occurring, do not fold or store the product if it is damp or wet.
- Always store the product in a well ventilated area.
- When using your stroller at the beach, completely clean your stroller afterwards to remove any sand and salt from the mechanisms and wheels. Sand and salt will cause premature wear and corrosion.
- If there are compression marks on the tires, use a domestic hair dryer to gently warm (DO NOT OVERHEAT) the tire and the compression marks should slowly disappear.
- Always check parts regularly for tightness of screws, nuts, and other fasteners. Tighten if required. To maintain the safety of your Infinity Stroller, seek prompt repairs for bent, torn, worn or broken parts by contacting Evolur.

**Dream On Me Inc.**

**1532 S Washington Ave, Piscataway TWP, NJ 08854**

**Tel: 732-752-7220**

**Fax: 732-752-7221**

**MADE IN ZHONG SHAN, CHINA**



**CAUTION**



This CAUTION Symbol is shown at certain steps in this Instruction Manual to highlight the danger of being injured by moving parts.

## Parts list

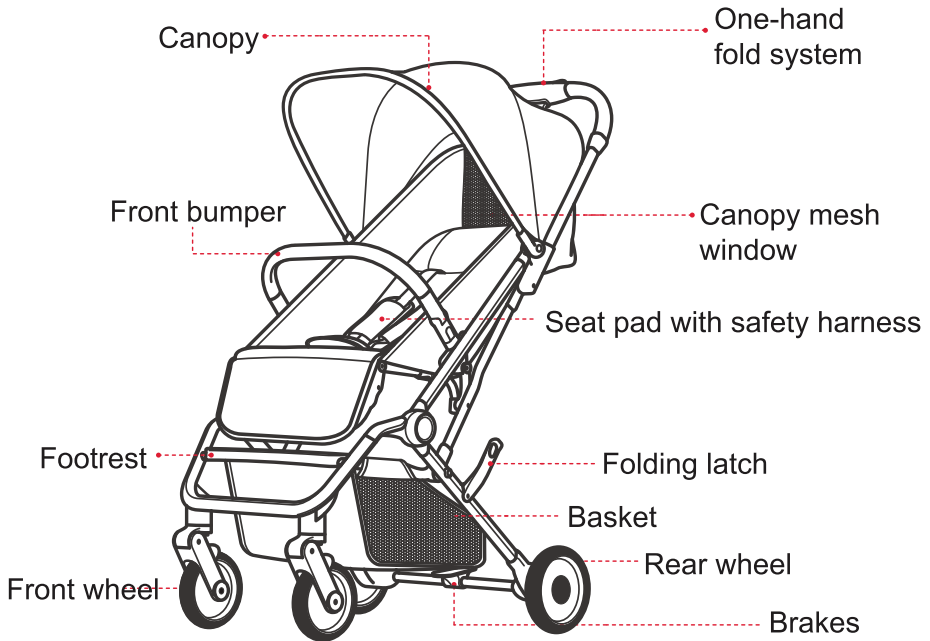
Please check to make sure that all of the following parts listed are included in the box when opened. If there are any missing parts, please contact Evolur before using the Infinity Stroller.

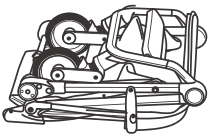

Please check to make sure that all of the following parts listed are included in the box when opened. I there are any missing parts, please contact your local retailer before using the product.

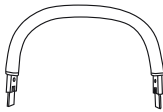
		
Frame with canopy and front wheels x1	Rear Wheel x 2	Bumper Bar x1

## 1. To Open Stroller

(1) Open the folding latch. Fig. A

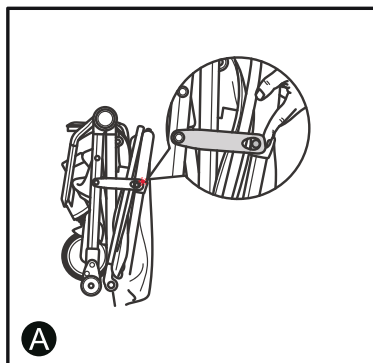

(2) Lift up the handle of stroller to open the stroller until hear a “Click”.  
Fig. B & C

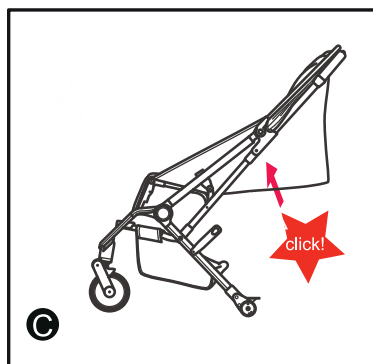
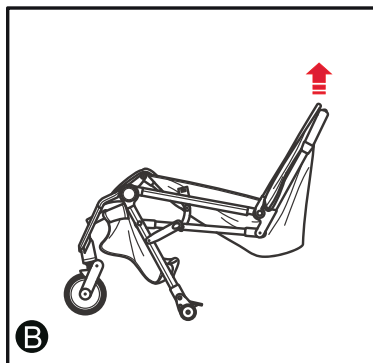

**CHECK** that the stroller is completely latched open every time you open the stroller and before continuing with the rest of the assembly steps.

## 2. Rear Wheels

(1) Attach the rear wheels to the stroller.

Fig. A.

**CHECK** that wheel is securely attached by tugging on the wheel.

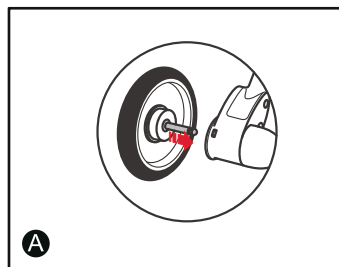

(2) For easy transportation and storage, remove the rear wheels by pushing the button shown. Fig. B.

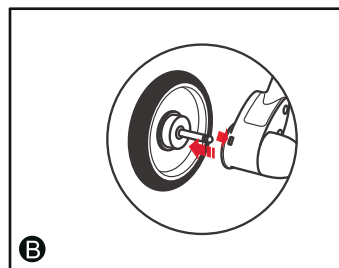

## 3. Use of the Bumper Bar

(1) **Assembling the Bumper Bar:** Push the bumper in each slot to install until it clicks into place. Fig A.

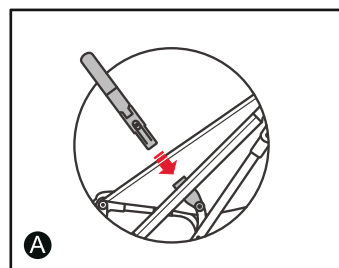

(2) **Removing the Bumper Bar:**

Press the buttons on the sides of the Bumper Bar together and pull it off to remove it. Fig B.

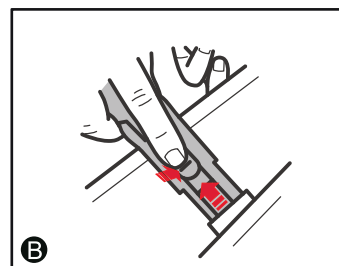

 **WARNING:**

**KEEP THE BUMPER BAR ATTACHED TO THE FRAME AT ALL TIMES WHEN THE CHILD IS IN THE STROLLER.**

## 4. Using The Canopy

### (1) Fold the canopy

Push backward to fold the canopy, as shown in Fig A.

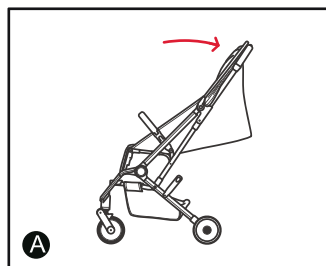

### (2) Fold the canopy

Push forward to open the canopy, as shown in Fig B.

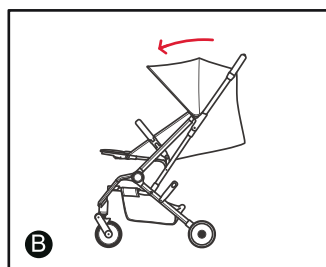

## 5. Using The Brakes

(1) **Parking the brakes:** Push the outside brake lever down to park, as shown in Fig. A

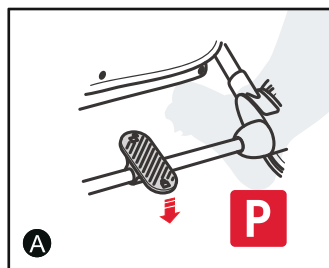

(2) **Loosening the brakes:**  
Push the inside brake lever to loosen the brakes, as shown in Fig. B

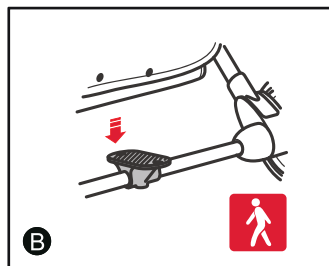

**⚠ WARNING:**  
**ALWAYS APPLY THE BRAKES WHEN THE STROLLER IS STATIONARY.**



## 6. How To Adjust The Backrest

### (1) Adjustment of the upright position:

Pull the 2 straps as shown in Fig. A to move the backrest to the upright position.

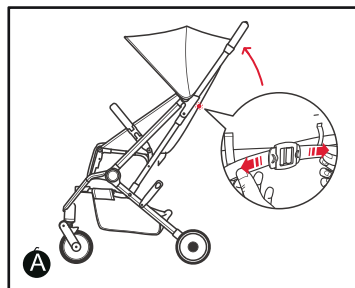

### (2) Adjustment of the reclined position:

Squeeze the buckle to loosen the straps as shown in Fig. B and pull down to recline the backrest.

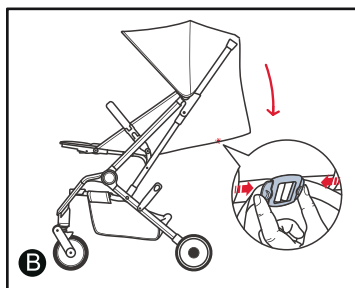

## WARNINGS:

- THE UPRIGHT POSITIONS ARE NOT SUITABLE FOR USE WITH CHILDREN LESS THAN 6 MONTHS OLD.
- THE LOWEST RECLINE POSITION SHOULD BE USED FOR BABIES. THE BACKREST CAN BE ADJUSTED TO UPRIGHT POSITION AS THE CHILD GROWS OLDER AND IS ABLE TO SUPPORT ITS HEAD WITHOUT ASSISTANCE.

NOTE: IF THE CHILD IS SITTING IN THE SEAT, SUPPORT THE BACKREST AS IT RECLINES. IF YOU HAVE DIFFICULTY ADJUSTING THE BACKREST, YOU MAY NEED TO REMOVE THE CHILD FROM THE SEAT TO ALLOW YOU TO RAISE OR LOWER THE BACKREST WITH EASE.

## 7. Footrest Height Adjustment

(1) Press the 2 buttons on the sides of the footrest and lowering the footrest to the lower position, as shown in Fig A.

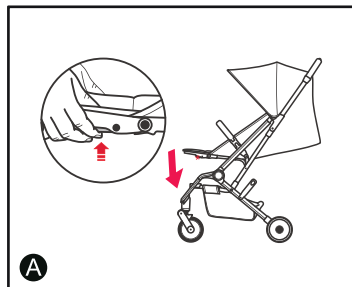

(2) Pull up the footrest to adjust it to be horizontal position, as shown in Fig B.

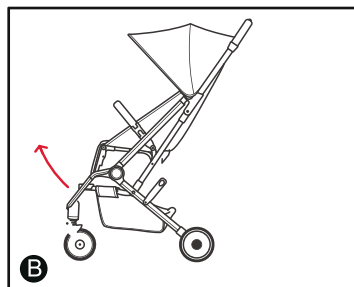

### **WARNING:**

**THE FOOTREST FEATURE IS PROVIDED FOR YOUR CHILDS COMFORT. THE FOOTREST IS NOT DESIGNED TO SUPPORT EXTRA WEIGHT. DO NOT ALLOW CHILDREN TO STAND OR SIT ON THE FOOTREST.**

## 8. FOOT BARRIER



### WARNING:

For 0 ~ 6 MONTHS BABY, THE FOOT BARRIER HAVE TO BE USED.

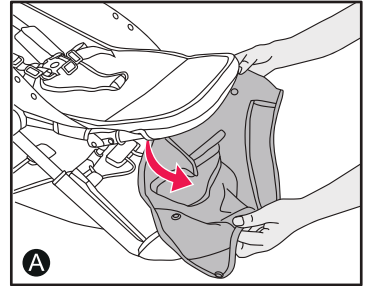

(10) The Foot Barrier is under the Footrest, take it out as shown in Fig. A.

Put the bumper bar go through the Foot Barrier, then attach the bumper bar to stroller frame, as shown in Fig B.

Attached the Foot barrier to the side of the seat with the two Snaps at each side, as shown in Fig. C.

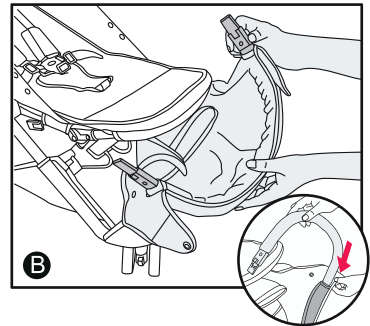

Please fold and store the foot barrier in pocket under the footrest while not in use

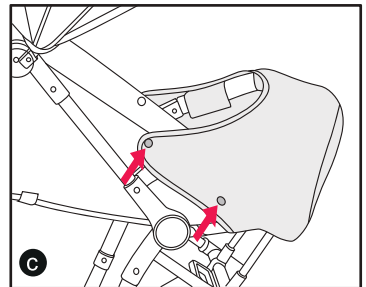

### WARNING:

Child may slip into leg openings and strangle. Never use in reclined position unless the foot barrier is set up in position.

## 9. Securing Your Child To The Harness

(1) Press the button in the center to open the harness, as shown in Fig A.

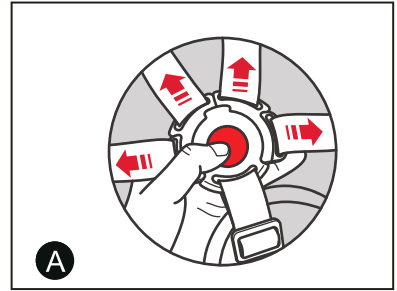

(2) Push both buckle tongues into the buckle housing until the buckle tongues lock into position (Fig B).

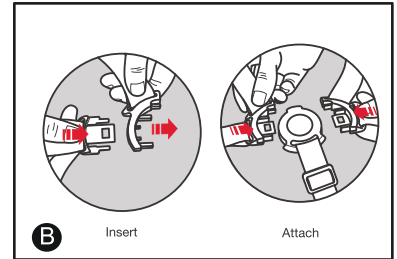

(3) Tighten or loosen shoulder and crotch straps by sliding the bar sliders up and down (Fig C).

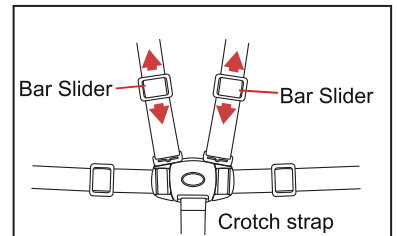

(4) To tighten or loosen the waist straps, hold and lift the 4 bar sliders, then pull the harness strap to adjust to the desired fit. The waist strap needs to fit firmly around the child (Fig D).

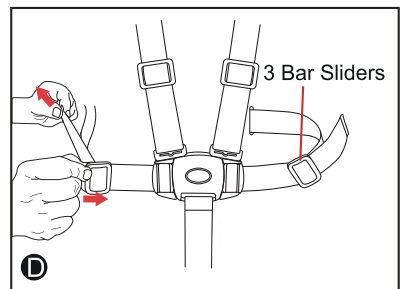

## 9. Securing Your Child To The Harness

(5) The stroller seat has 3 sets of harness slots at different heights to accommodate the child. To change the shoulder harness height, push the shoulder harness tongue out of the current harness slot and through fabric slots.

To reposition harness, pull the shoulder harness buckle tongue through the desired slot (Fig E/F).

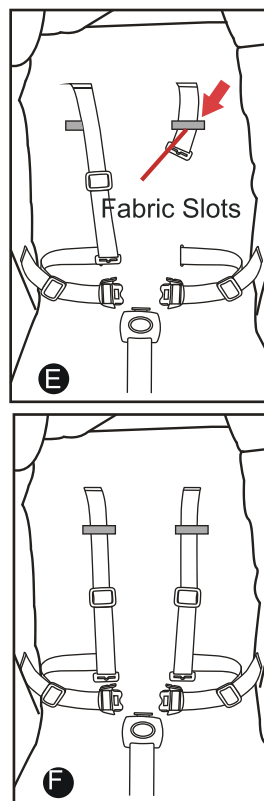

**⚠ WARNING: USE THE HARNESS AT ALL TIMES.**  
**When not in use, disconnect shoulder straps from the waist strap and buckle to prevent strangulation.**

A five point harness is provided to restrain your child. Buckle tongues separate for added safety. To reconnect buckle tongues and to secure the child in the harness, please follow the steps below carefully.

## 10. To Fold The Stroller

(1) Fold the canopy, as shown in Fig. A

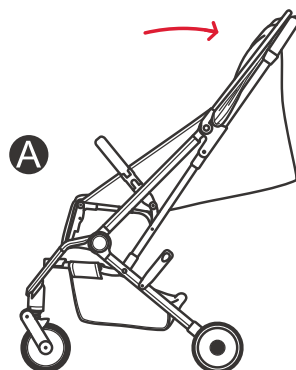

(2) Hold down button 1 to left and squeeze on button 2. Then, push the handle bar downward, as shown Fig. B, until the folding latch locks into position as shown in Fig. C

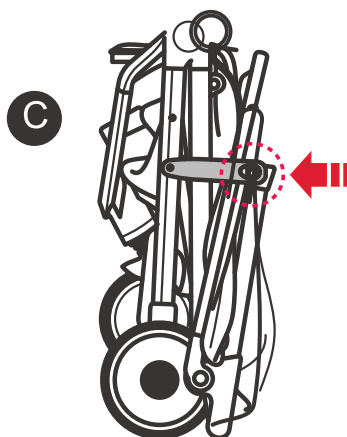
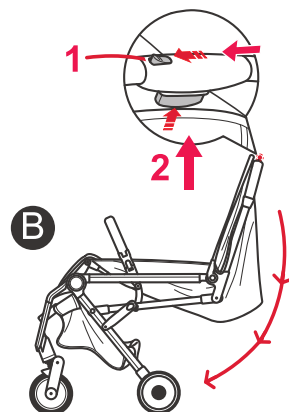

## 10. To Fold The Stroller

(1) Fold the canopy, as shown in Fig. A

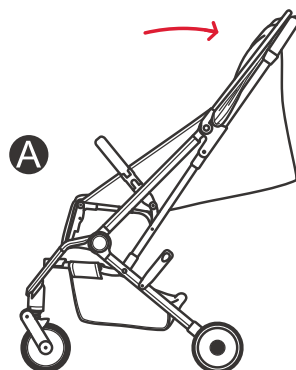

(2) Hold down button 1 to left and squeeze on button 2. Then, push the handle bar downward, as shown Fig. B, until the folding latch locks into position as shown in Fig. C

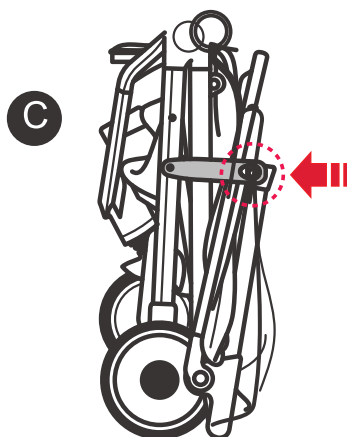
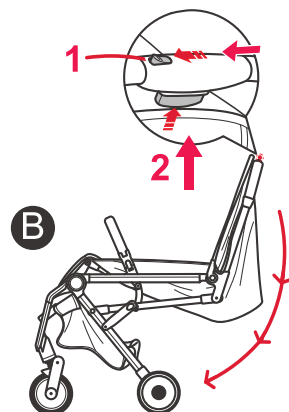



1532, S. Washington Avenue  
Piscataway, NJ 08854  
E-mail: [info@evolurbaby.com](mailto:info@evolurbaby.com)

[www.evolurbaby.com](http://www.evolurbaby.com)

Follow us on



@EvolurBaby



@evolurbaby

to get your nursery featured on our social media.

Enter our monthly giveaway!

Simply scan the QRcode to register.



Chat with us!

For any questions or concerns or feedback.

